

**Rockland County  
Update May 22, 2014**

**Temporary Trestle  
and New York State Thruway  
Bridge Maintenance Dock**



# Rockland Temporary Trestle

May 5, 2014



# Rockland Temporary Trestle

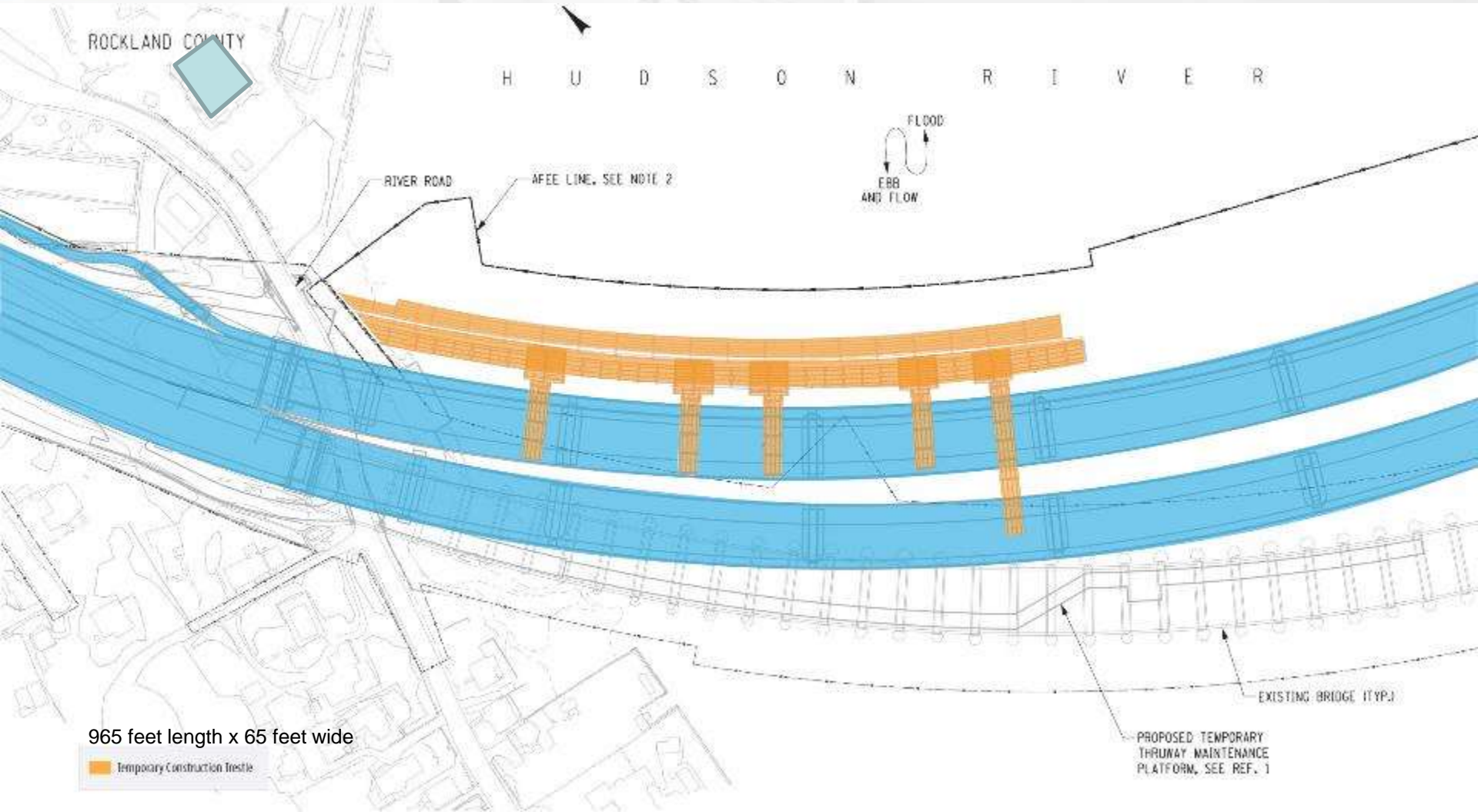

ROCKLAND COUNTY

H U D S O N R I V E R

RIVER ROAD

AFEE LINE, SEE NOTE 2

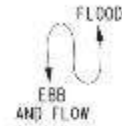

EXISTING BRIDGE (TYP.)

PROPOSED TEMPORARY THRUWAY MAINTENANCE PLATFORM, SEE REF. 1

965 feet length x 65 feet wide

Temporary Construction Trestle

# Rockland Temporary Trestle

- ◆ To be complete June 2014
- ◆ 965' length x 65' wide
- ◆ Construct piers two, three and four
- ◆ Support marine activities
- ◆ Reduces the amount of dredging

# Thruway Maintenance Dock

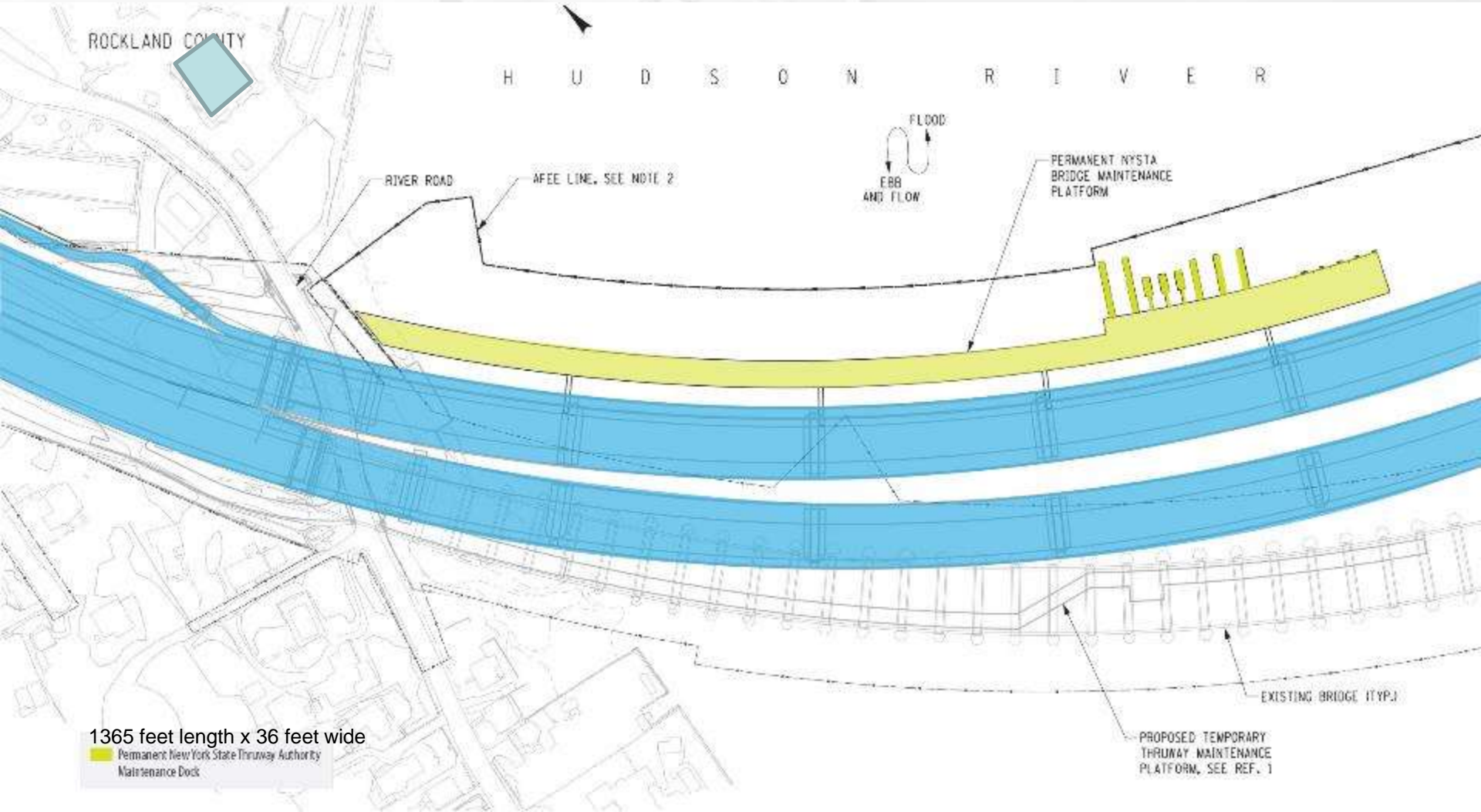

1365 feet length x 36 feet wide

Permanent New York State Thruway Authority Maintenance Dock

PROPOSED TEMPORARY THRUWAY MAINTENANCE PLATFORM, SEE REF. 1

EXISTING BRIDGE (TYP.)

PERMANENT NYSTA BRIDGE MAINTENANCE PLATFORM

FLOOD  
EBB AND FLOW

OFFICE LINE, SEE NOTE 2

RIVER ROAD

ROCKLAND COUNTY

H U D S O N R I V E R

# New York State Thruway Bridge Maintenance Dock

- ◆ To be complete Spring 2018
- ◆ 1365' length
- ◆ 36' wide, blossoms to 57' at the tip
- ◆ 5 piers/fingers
- ◆ Aluminum Floating docks
- ◆ 8' above water
- ◆ 13' from new bridges (hugs the bridges contour)
- ◆ 42" galvanized railing
- ◆ Controllable lighting
  - 15' high light post
  - Full cut off - dark sky compliance
  - Located every 50 feet
  - Every third light is on when dock is not in use

# EIS TRESTLE

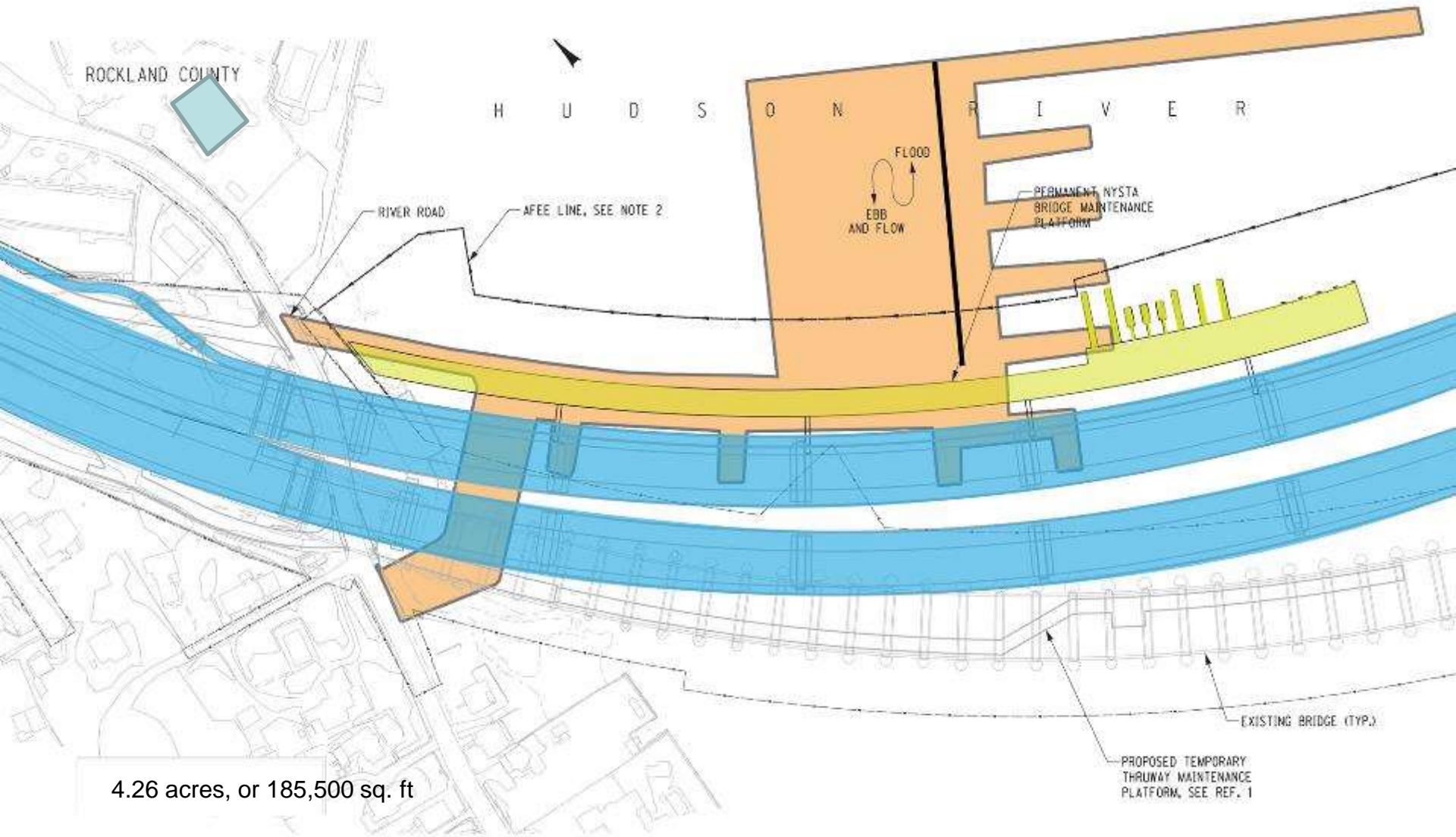

4.26 acres, or 185,500 sq. ft

PROPOSED TEMPORARY  
THRUWAY MAINTENANCE  
PLATFORM, SEE REF. 1

EXISTING BRIDGE (TYP.)

PERMANENT NYSTA  
BRIDGE MAINTENANCE  
PLATFORM

FLOOD  
EBB  
AND FLOW

H U D S O N R I V E R

ROCKLAND COUNTY

RIVER ROAD

AFEE LINE, SEE NOTE 2

# New York State Thruway Bridge Maintenance Dock

- ◆ New York State Thruway Marine access
- ◆ Two tug boats
- ◆ Four smaller boats
- ◆ Support maintenance of new bridge
- ◆ Normal operations weekdays 7 a.m. to 3 p.m.
- ◆ Minimal vehicular usage – crew pickup
- ◆ No public access



# Rockland Temporary Trestle

May 5, 2014



# Dockside Maintenance Building Demolition



# Sheet Pile Installation

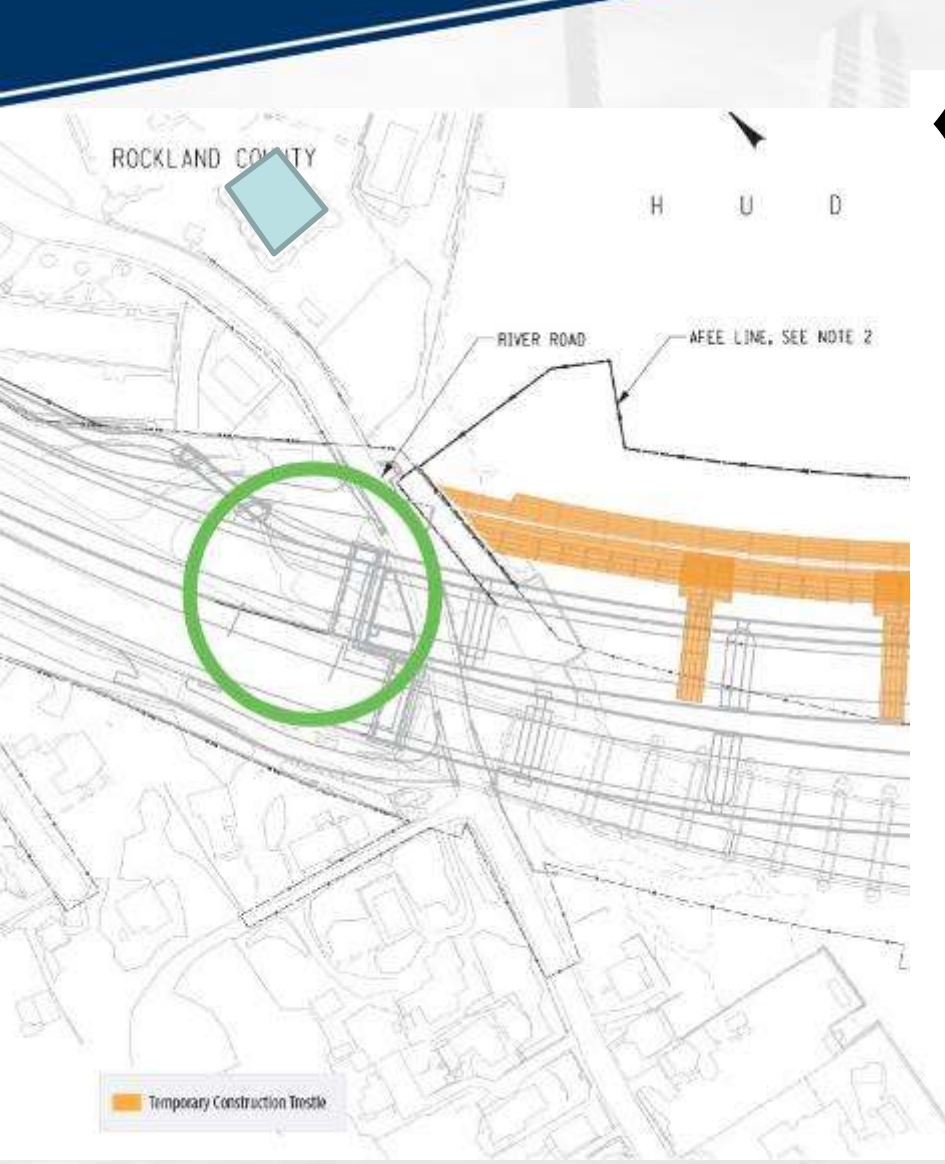

## ◆ Sheet Pile installation

- Using vibratory hammer to drive the sheets
- Short duration per sheet
- Start June 2, 2014
- Approximately 3 week duration
- Daytime hours

# Sheet Pile Installation

- ◆ 165' Crane
- ◆ Some sheet piles up to 60 feet high prior to installation

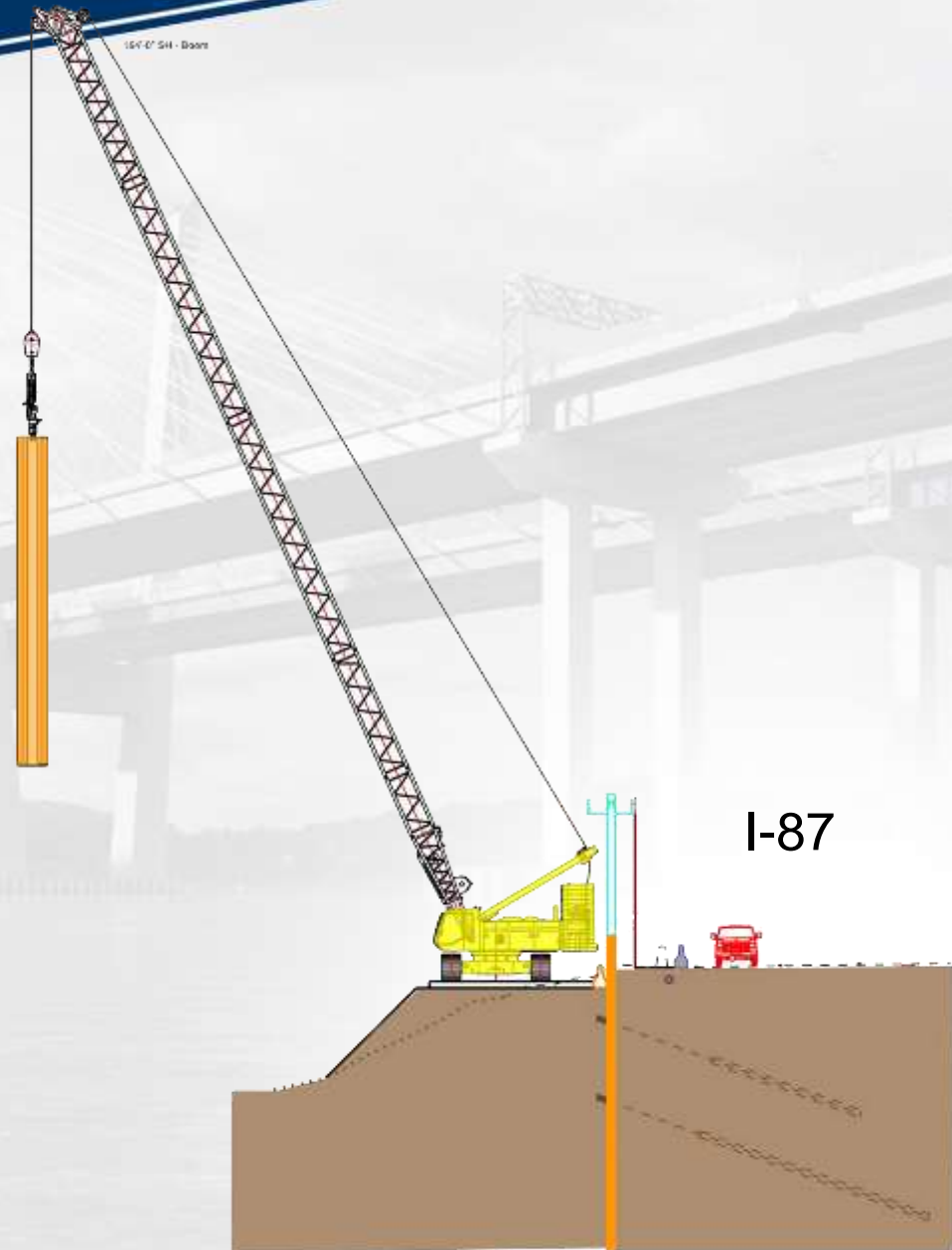

# Sheet Pile Installation

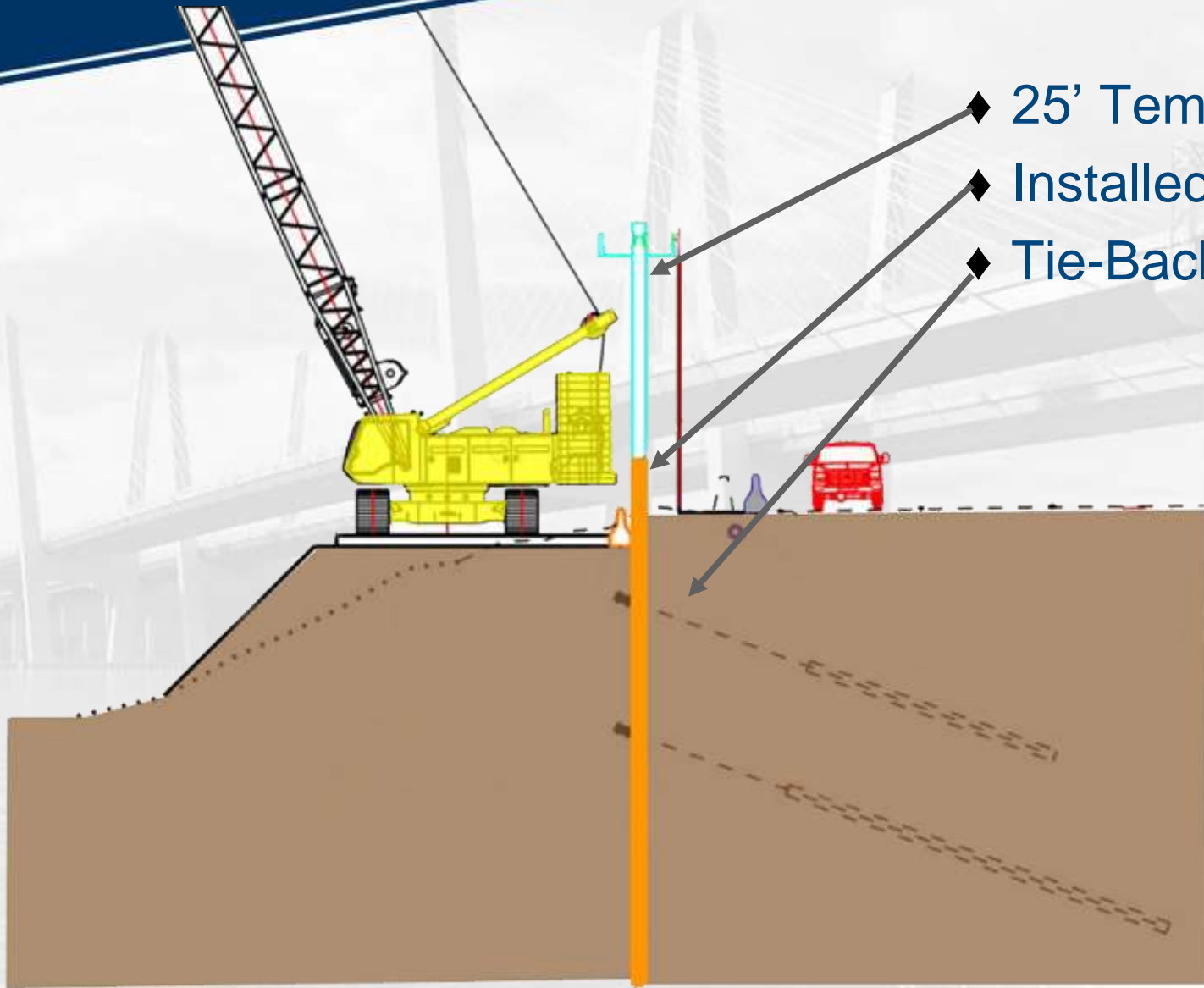

- ◆ 25' Temp Frame
- ◆ Installed Sheet Pile
- ◆ Tie-Backs

I-87

# Sheet Pile Installation

Installed Sheet Pile

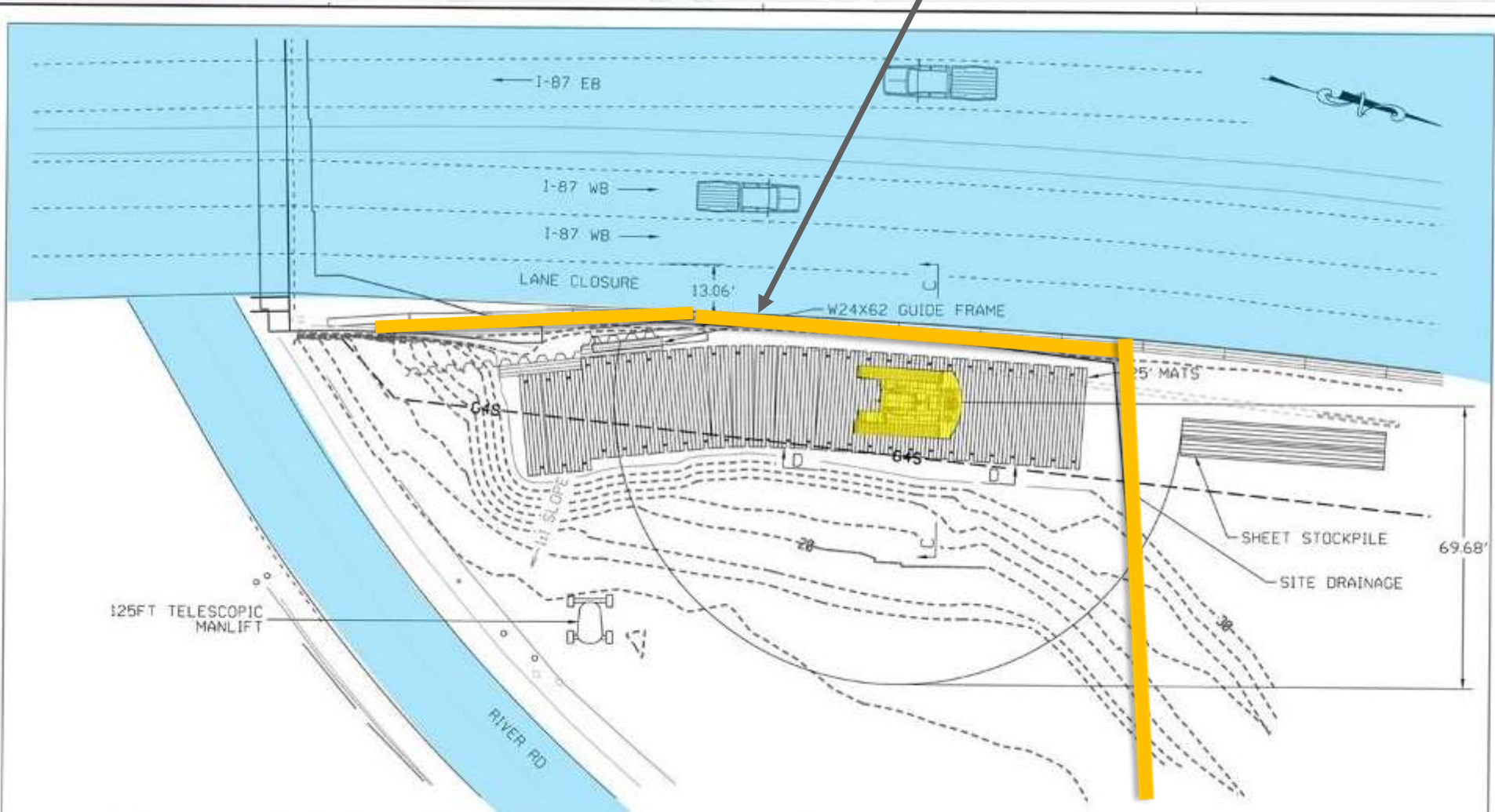

# Concrete Batch Plant

- ◆ 2 Floating Concrete Batch Plants
- ◆ Materials brought to project via river
- ◆ Complies with environmental commitments
- ◆ Reduces local truck traffic
- ◆ Each plant can produce 150 cubic yards per hour
  - 2 plants produce the equivalent to 30 Cement trucks per hour

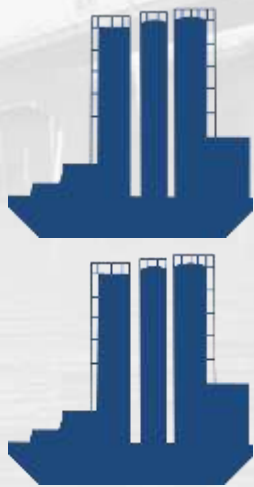

# Concrete Batch Plant





# Update

- ◆ Utility work continues
- ◆ Tree removal including removal of stumps – now through June
- ◆ Transite pipe removal – mid June
- ◆ Temporary sound walls have been installed
- ◆ Southbound section of retaining and sound walls - Summer 2014
- ◆ Northbound near S. Broadway - Remove trees Nov–Dec 2014
- ◆ Northbound - remove remaining sound walls – Early 2015
- ◆ Northbound - build retaining and noise walls Spring/Summer 2015

# River Road



# River Road



# Questions?

